

# TRANSMITTER & AIRCRAFT INTRODUCTION

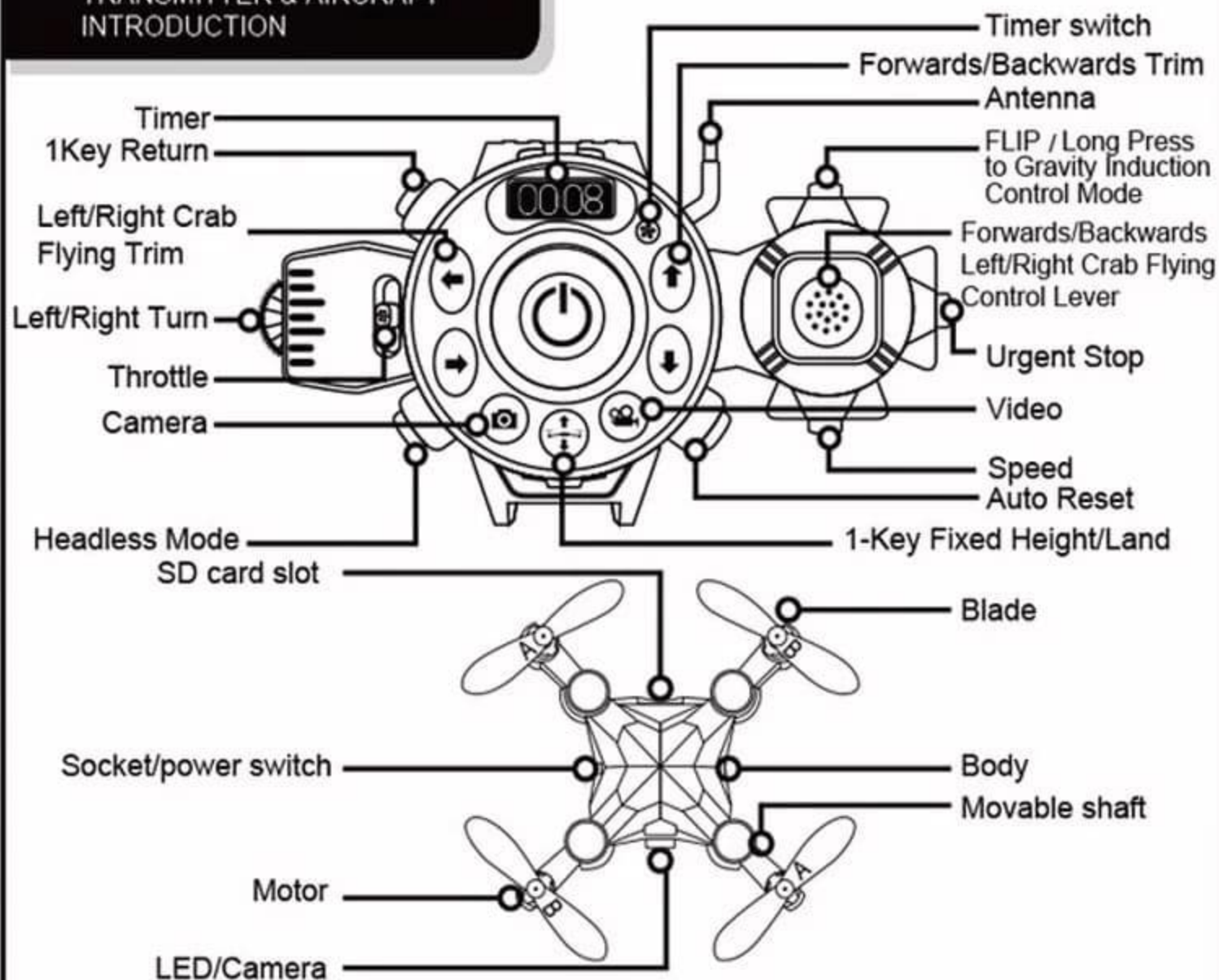

PS: Replace the blade according to the corresponding location of the propeller AB in the figure.

# PORTABLE REMOTE CONTROL WATCH STYLE MINI FOLD DRONE

## Instruction manual

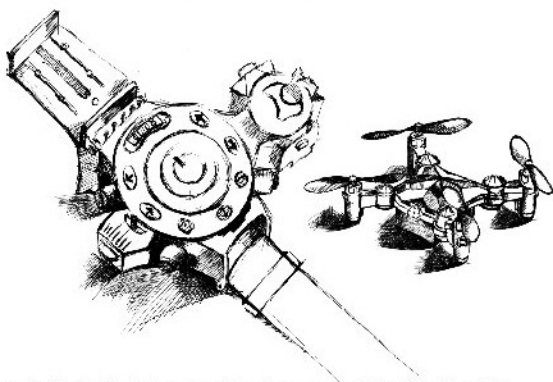

The product design inspiration comes from the concepts of classical ship rudder, classical noble telephone dial and portable watch. The integration of these 3 concepts, we design a new creative watch style controller. Multiple play modes, easy to control, we open the mainstream!

### Important:

- Our products used gyroscopes. It can fly in small space or outdoor, On the outside, it can meet your desire for flying if the wind is not more than level 3.
- The drone uses 2.4 G control system, with longer remote control distance, which can realize many palyers play together at the same time and won't have mutual interference. You can control the drone flies forward, backward, left/right crab, turn left/right, one key take off landing, timing, emergency stop flying, 8 basic functions of gyroscope such as trimming the quadcopter, recalibrating the quadcopter, and flip function.
- In order to operate the drone easily, please read the manual carefully before using and retain the manual.

### SAFTY&CAUTIONS

1. Please put the smaller parts of drone at place where children can't touch, avoid accidents.
2. The drone has powerful energy, at first flight, you should slowly push left lever. Avoid drone flies rapidly and result in collisions and damage.
3. After flight, turn off the remote control and the drone.
4. Do not put the battery in the high temperature, hot place. (such as: near the fire or electric heating device)
5. During flight, the drone should keep away from the user or others about 2-3 meters. Avoid injure others when the drone lands.
6. Do not let children play alone, children should play under the guidance of adults.
7. Non rechargeable batteries are not rechargeable, install batteries with correct polarity and do no mix different types of batteries.
8. When stop flying please turn off the power of transmitter and remove the batteries of drone and transmitter out.
9. The power supply terminal can not be short circuit.
10. Don't look the light directly because it has radiation.

### Flying Preparation

- 1: Stretching the drone.  
Clockwise rotate the four wings of drone in turn, stretch the drone to the flying condition.  
(as pictured to the right)

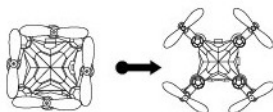

2. Syncing the drone.  
Turning on the drone, keep it in a horizontal position.  
Then turn on the transmitter, the bottom four LED lights flash quickly.  
Push the throttle lever to the highest position, then pull it back to the lowest position, there will be one clear sound from the transmitter, it shows the sync finishes

3. Calibration  
Press the auto reset button, The bottom four LED lights flash quickly, then become bright allthrough, it means the calibration succeeds.

Note: Before flying, the drone need to be calibrated.

4. Low power alarm  
When the drone is in the low battery state, the bottom four LED lights keep flashing slowly. The flight should be stopped. You need to charge the drone.

## FLIGHT TIP

### Conventional Flying Mode:

1. Turn the power switch on; put the drone on the ground, the lights will flash.
2. Turn on the remote control switch, after drone syncing with the remote successfully, the drone will be solidly light on. To sync the drone and the remote, pull the throttle joystick to the bottom and then push it to the top.
3. Press the functional button "Auto Reset" on transmitter.
4. Turn the transmitter throttle stick from bottom to top, and then turn it back to bottom, now the transmitter aim to the drone successfully and unlock the drone flying.
5. Turn the transmitter throttle stick about 30% from bottom to the top, the drone will fly; turn the throttle stick back to the bottom, the drone will keep flying down and land on the ground finally.

### Fixed Height Flying Mode:

1. Turn the drone switch on, and then put the drone on the floor.
2. Press the functional button "1-Key Reset" on transmitter.
3. Turn the transmitter throttle stick from bottom to top, and then turn it back to bottom, now the transmitter aim to the drone successfully and unlock the drone flying.
4. Press the functional button "1-Key Fixed Height" on transmitter, the drone will fly up to 1.2 meter height default.
5. Turn the throttle stick up; the drone will fly to any height once you stop turning the stick. Turn the throttle stick back to the bottom, the drone will keep flying down and land on the ground finally, it will automatically stop flying 2 seconds after landing on the ground.
6. Here is one key landing function on this product, press the one key landing button, drone flying down to the ground within 2 seconds to stop immediately.

## TRANSMITTER & AIRCRAFT INTRODUCTION

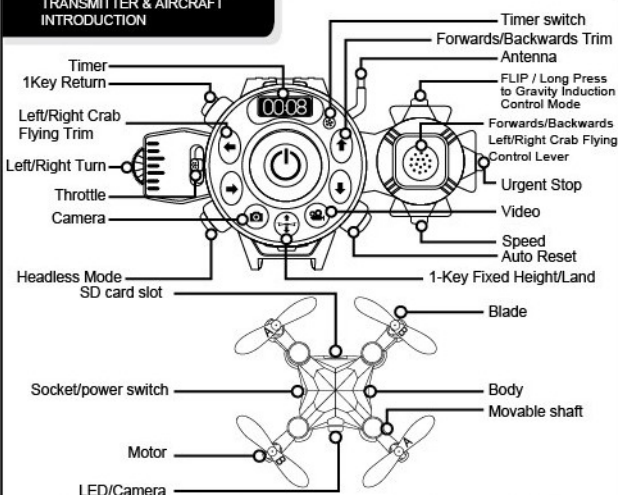

PS: Replace the blade according to the corresponding location of the propeller AB in the figure.

- 1 -

## Instructions

	 Push the throttle lever up or down, the drone flies upward or downward.
	 By turning the steering wheel, the drone will turn left /turn right correspondingly
	 Push the direction lever up or down, the drone flies forward or backward.
	 Push the direction lever left or down, the drone flies to left side or right side.
	 Press the flip function button, and push the direction joystick forward, the drone will flip forward.

- 6 -

## Installation and adjustment

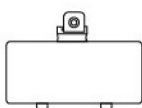

Battery cover

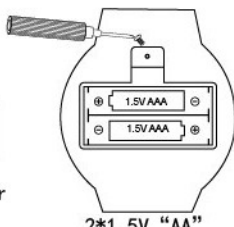

2\*1.5V "AA"

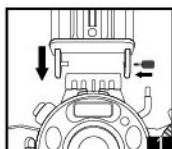

1. Insert the mobilephone holder at the slot of the top of remote control, to install the phone holder.

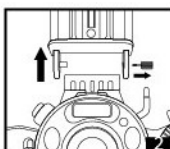

2. Press and hold the positive side of the remote control (as arrow shown in figure) to loose the screw with a screwdriver, to take out the mobilephon holder.

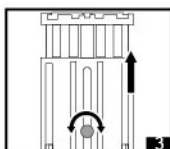

3. You can rotate the metal parts anticlockwise to pull up or shrink the telephone rack. Then rotate the metal parts clockwise to fixed it after you adjusted the width of the telephone rack.

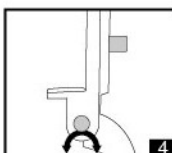

4. You can rotate the metal parts which on the side of telephone rack to adjust the angle of telephone rack, then rotate the metal parts clockwise to fixed it.

	<p>Vertically hold the direction lever and push backward, the drone does 360° backward rolling action.</p>
	<p>Vertically hold the direction lever and push left, the drone does 360° rolling action on the left side.</p>
	<p>Vertically hold the direction lever and push right, the drone does 360° rolling action on the right side.</p>
	<p>After syncing the drone and the remote, press the altitude hold button, drone will automatically assend 1.2 m high, and stationary hover in mid-air.</p>
	<p>Presses the landing button, the drone will automatically landing smoothly on the ground. The drone will automatic stop within 2 second</p>



### Battery charging

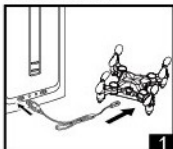

Turn off the aircraft, using the USB charging line to connect the charging plug of drone and the USB interface of computer.  
The USB charging line lights when charging, the light goes out when charging finish.  
Charging time is about 60 minutes.

## Headless Mode

★ Start and setting: put the drone in a horizontal position or make it hovering in the air and confirm the front of drone (blue LED light) with the transmitter in the same direction ahead. Pressing the button of headless mode (Remote control sounds "BEBE"), drone diagonal LED light flash. It means open the headless mode.

★ Drop out the headless mode: Pressing the button of headless mode (Remote control sounds "BEBE", finish the exit), drone LED light. It means drop out the headless mode.

★ You can switch to the headless mode at any time even in flying.

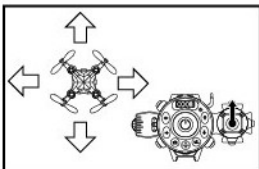
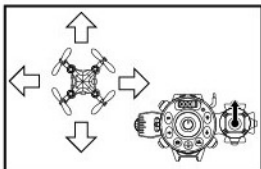
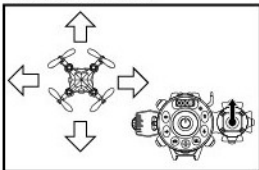
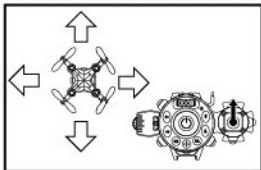
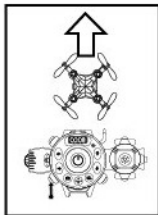

- 3 -

## Attention

- Keep a suitable distance from the aircraft for safety.
- Do not look straightly to the lights, as the lights may generate laser radiation.
- If the transmitter or drone is lack of power, the control distance and height of flying will be affected.
- If the drone is broken, please repair it in time. Do not use drone with damaged propellers.
- Please put out the batteries to avoid battery leakage when do not be used for a long time.
- Do not let the drone crash at a high altitude, because the drone will be damaged and its lifetime will be shorter.

## Special note

Push the the throttle lever slowly, You can use the button of trimmer to correct if the drone spinning or deviating in the sky.

**Note:** The drone will have a reaction of Ground effect.

The drone becomes unstable when its blades swirl, this is "Ground effect".  
The Ground effect becomes bigger if the weight of drone is lower.

## Notes of using the li-po battery

- The use of lithium-ion batteries has certain risk, it may cause personal injury, or property damage.
- The user should bear all the responsibility.
- The manufacturers and dealers can't control batteries (charge and discharge and storage, etc.).
- Also can't be responsible for any personal and property losses.

### Charger and charge

- Use only factory supplied charger. Before cleaning the model, make sure the model is disconnected from the charger.
- Do not charge or use the swelling, leaking or damaged battery.
- Do not overcharge the battery. When the battery are fully charged, pull out the charge. After charge complete, do not recharge to avoid overheat.
- Do not charge near combustible or flammable (carpet, wood floor, solid wood furniture, etc.) or on surface of conductive objects. Should observe the battery at any time.
- Don't charge when the battery is still hot.
- The temperature of the battery is between 0°C and 40°C.
- Pull out the charger when not charged.

### Use and store

- Do not use plastic packaging has been damaged batteries.
- When the product is turned on, do not insert or remove the battery.
- Do not allow the battery to excessive physical shock.
- Do not use the expansion, leakage, breakage, or emits an odor of the battery.

- 8 -

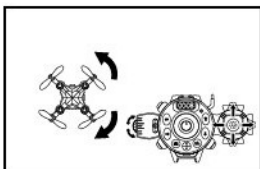
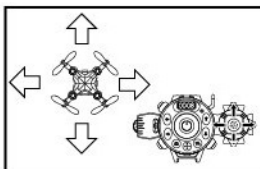

As shown in the above figure, in headless Mode (the bottom four LED lights keep flashing quickly) No matter where the drone locates (the blue light is the onward direction), now the position of the remote controller is the rear of the drone. At this time, push the direction lever down, the drone will come back, and push the direction lever up, the drone will fly far away.

### Gyroscope calibration

- ★ When the drone encounter impact or external collision or other reasons that lead to the deviation of direction, at the moment you can put the drone on a horizontal ground, then press the automatic calibration button on the remote control, the LED lights on bottom of the drone will flash and then be solid, that means you finish the direction of calibration.

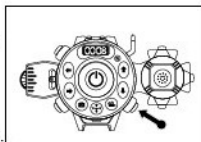

### One key return

- ★ Press the button of one key return, (the transmitter "BEBE"), the drone will return automatically. You can push the right lever up to correct the channel if off course. Press the button of one key return again (the transmitter "BEBE"), the drone end return. Or push the right lever up to end return.

## WIFI FPV INSTRUCTION

APP DOWNLOAD ADDRESS: PLEASE SCAN THE QR CODE.



We advise the beginner should practice within 10 meters.  
After you are skillful, you can control in far distance.

According to you mobile phone systems, scanning QR code and download the APP.  
Open Settings. Find the unlocked WIFI of drone, and connect it.  
Start the APP, click on the "PLAY" to enter a control page.

We can see effect of video if the connection is normal, it means the connection is successful.

- 4 -

- Children contact with battery is prohibited.
- Do not put battery into the fire, to avoid contact with liquid, the model can not be exposed to the rain, and should not be placed in the damp place.
- Please do not remove the battery or cut, drill. The battery or charger can not carry heavy things. Do not knock the battery.
- Do not use solvents, alcohol, or other flammable solvents to clean the charger.
- Prevent the short circuit. Avoid direct contact with electrolytic material of the battery, electrolytic material and electrolytic steam is harmful to the body.
- Store products under greenhouse. Please do not put product in extreme temperatures.
- Avoid the temperature of storage has important changes.
- Please do not place the product in the heat source.

### recycle

- Not handling the product as a daily garbage.
- The discarded battery should be placed in a special designated container
- The products consists of electronic element and batteries.
- With regard to discarded electrical and electronic, please handle it according to the special requirements. Please be familiar with the local waste treatment.

## main parameters

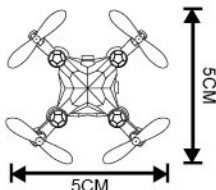
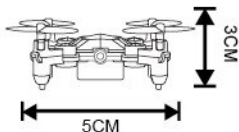

Battery: 3.7V 220 mAh Li-poly Charging time: about 60 minutes  
Main motor code: 6 Flying time: about 6 minutes



- 9 -